

Front Axo View

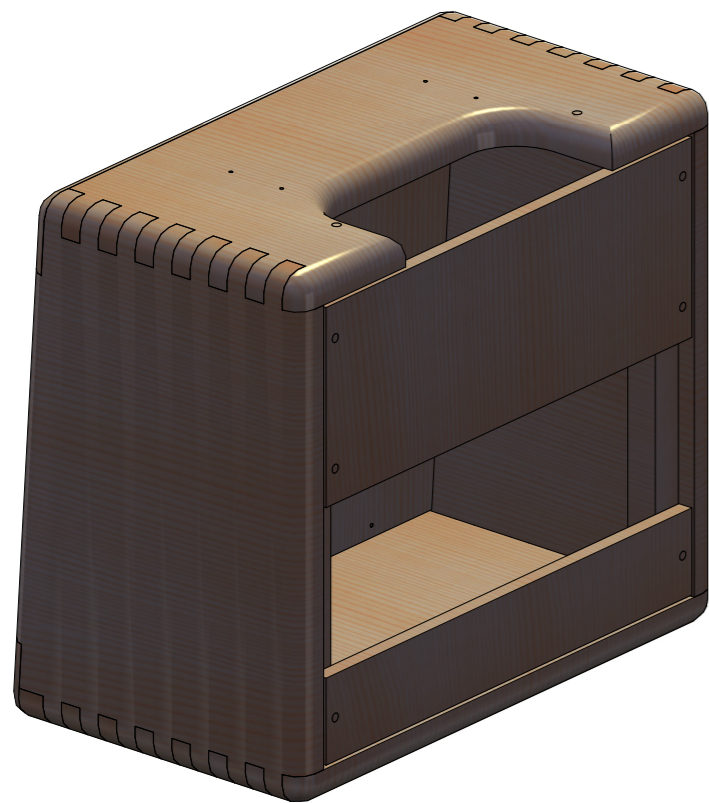

Rear Axo View

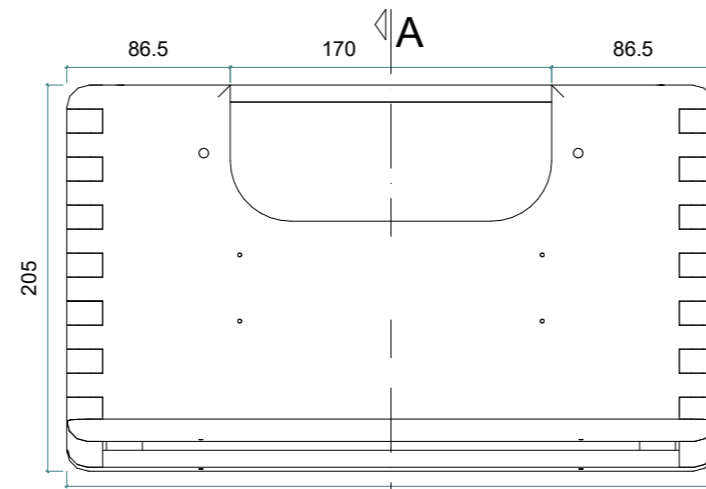

Plan View

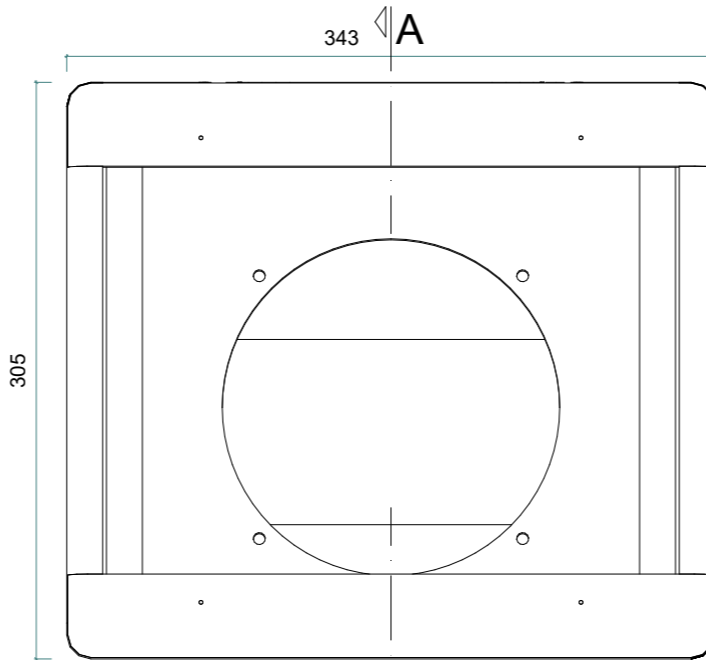

Front View

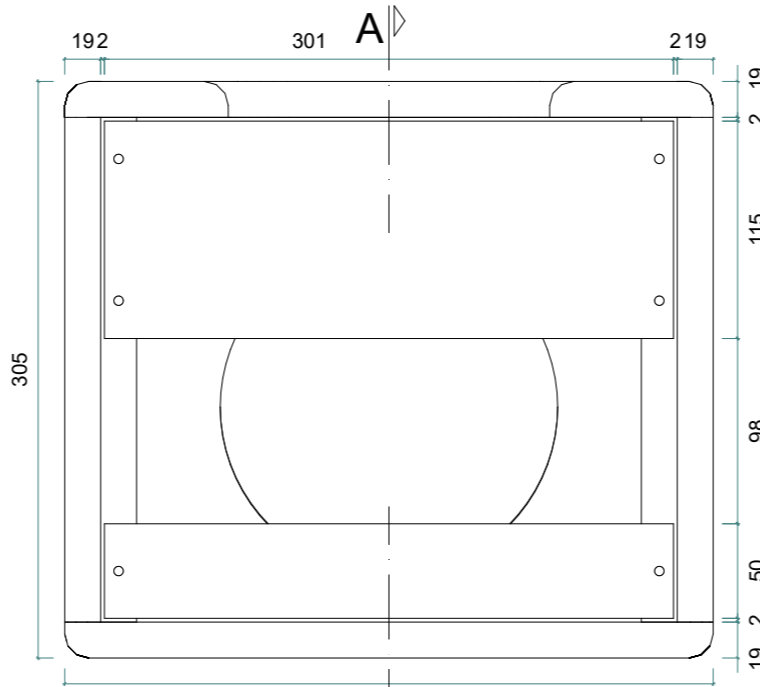

Rear View

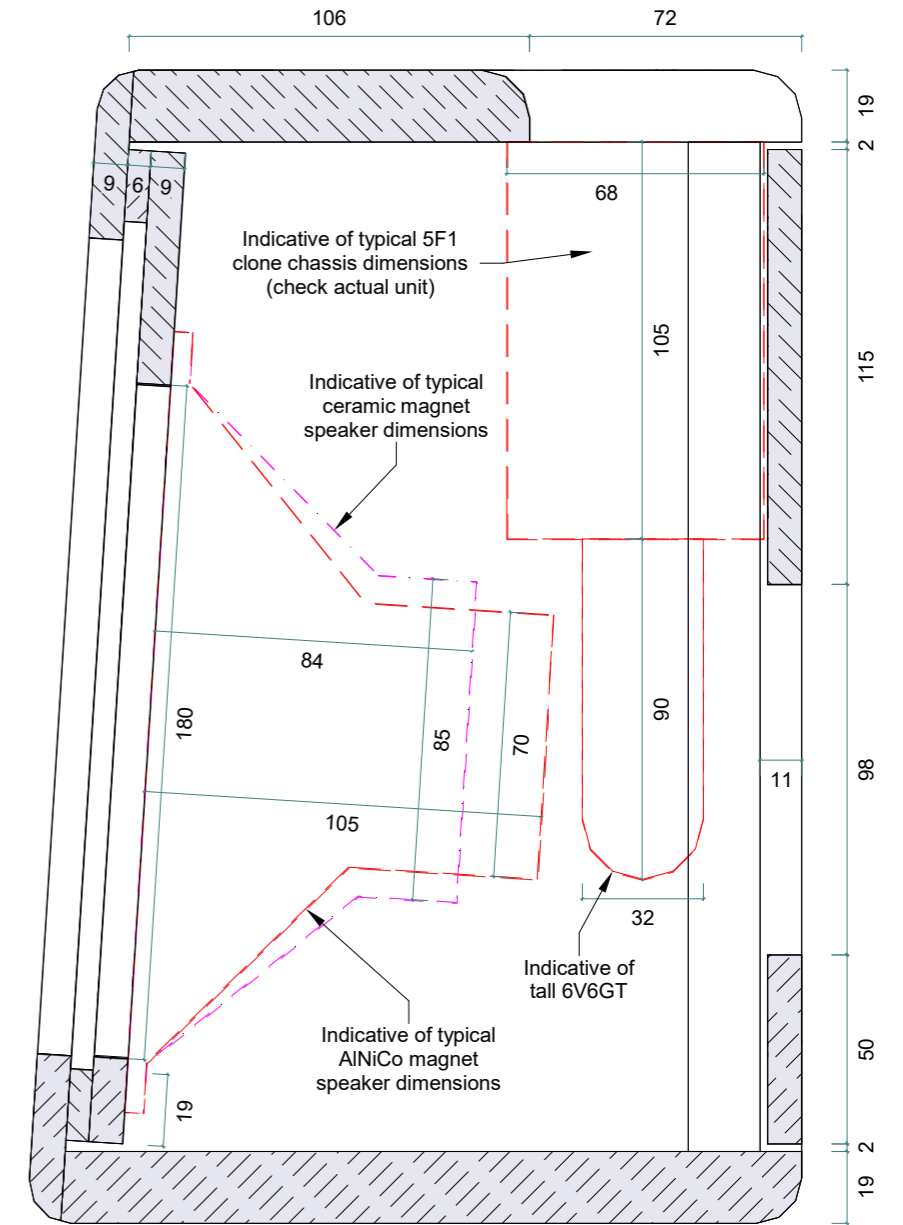

Section A-A

Scale: 1:2@A3

**Notes:**

- Drawings not to be reproduced without written approval.
- Check material thickness. Screw location and finger joint depth will have to be adjusted to suit.
- Allowances have been made for standard tweed covering and approx 2mm thick grille cloth.
- Dimensions may need to be altered for other materials or timber finishing.
- It's suggested that all screws be fitted with suitable T-nuts or threaded inserts for longevity. Hole diameter may vary with hardware choice.
- Trial and error may be required with some hardware.
- Speaker cutout and mounting holes may vary with manufacturers. Measure actual unit before drilling.



<b>Project</b>	Tweed cabinet plans				
<b>Title</b>	Champ 5F1 style cabinet - 8" Speaker				
<b>Project No.</b>	N/A	<b>Sheet No:</b>	1/2	<b>Issue</b>	A
<b>Drawn By</b>	BW	<b>Scale</b>	1:4@A3(UNO)	<b>Date</b>	27/01/2024

Lower Back Panel (9mm ply):

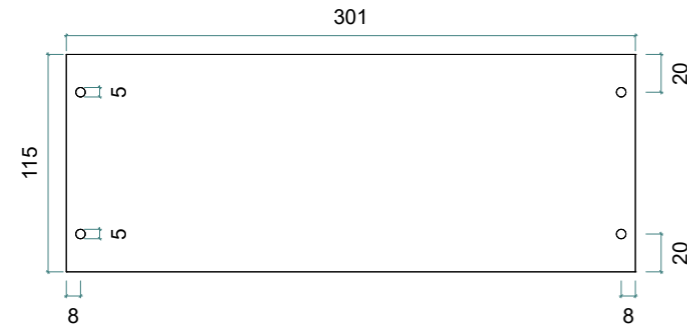

Upper Back Panel (9mm ply):

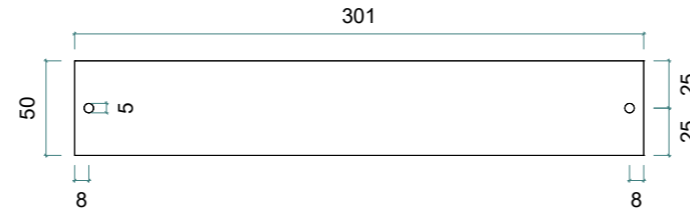

Back Panel Cleats (19mm solid pine):

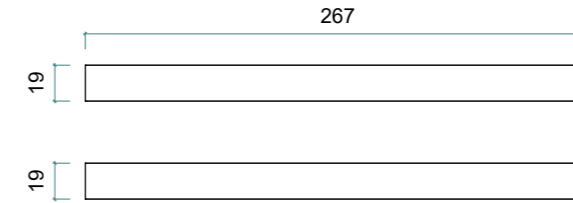

LH End (19mm solid pine):

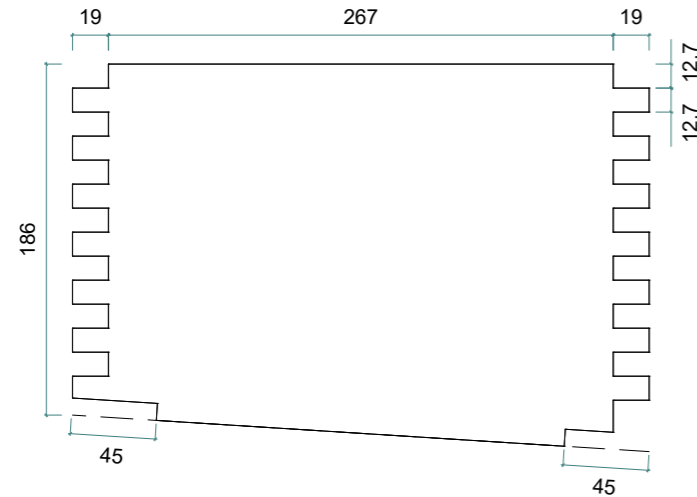

Top (19mm solid pine):

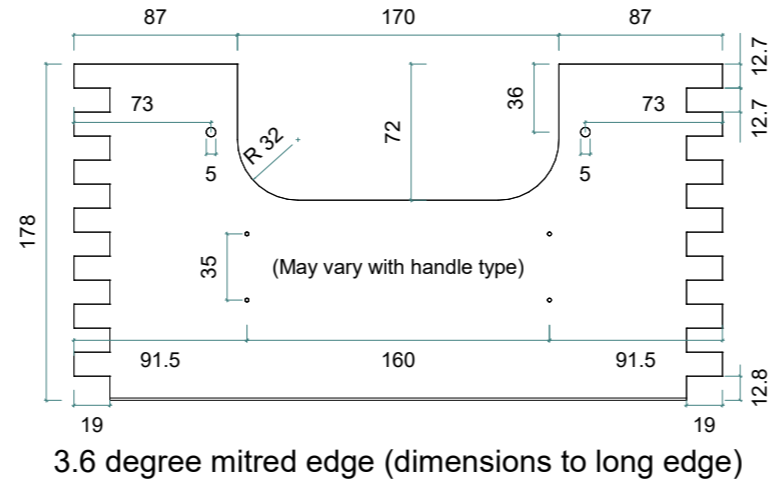

RH End (19mm solid pine):

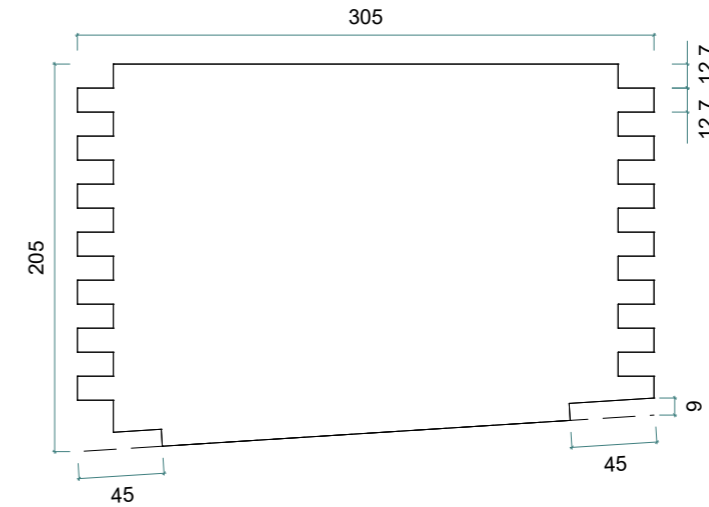

Baffle (9mm ply):

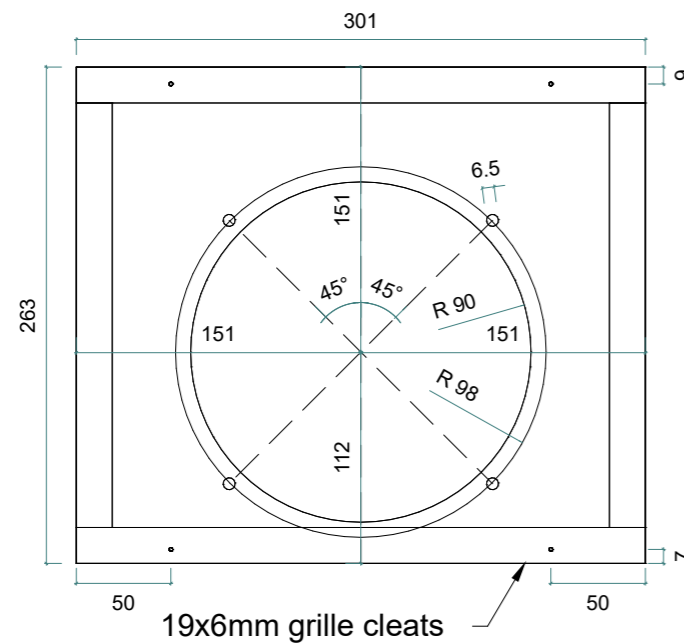

Base (19mm solid pine):

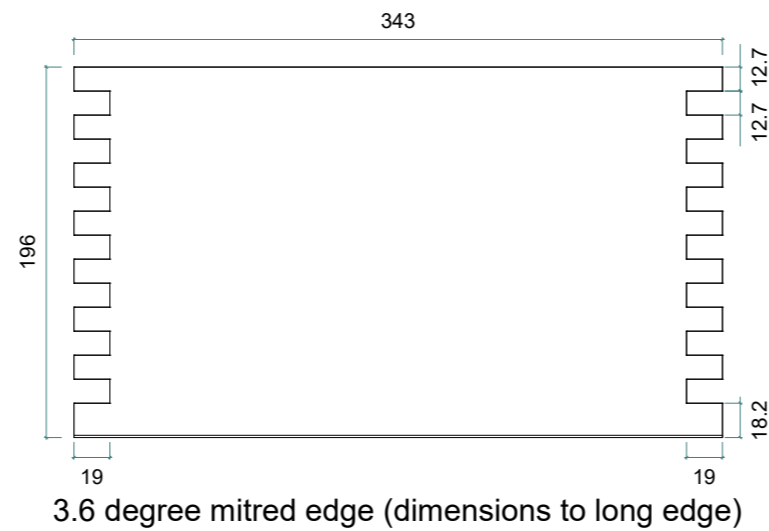

Face Panel Top (9mm ply):

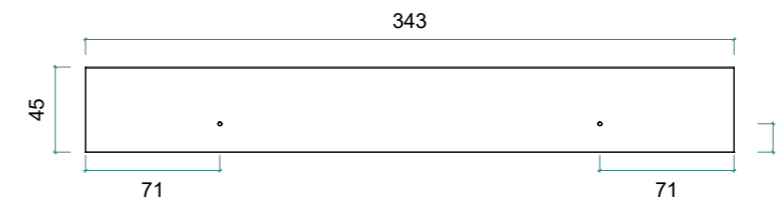

Face Panel Bottom (9mm ply):

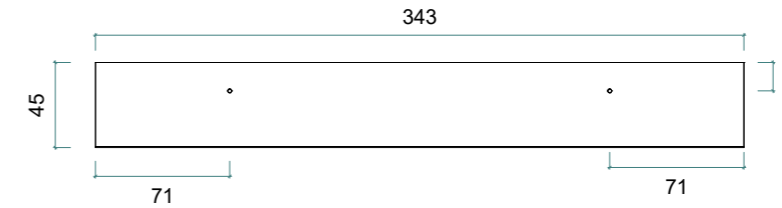

**Notes:**

- Drawings not to be reproduced without written approval.
- Check material thickness. Screw location and finger joint depth will have to be adjusted to suit.
- Allowances have been made for standard tweed covering and approx 2mm thick grille cloth.
- Dimensions may need to be altered for other materials or timber finishing.
- It's suggested that all screws be fitted with suitable T-nuts or threaded inserts for longevity. Hole diameter may vary with hardware choice.
- Trial and error may be required with some hardware.
- Speaker cutout and mounting holes may vary with manufacturers. Measure actual unit before drilling.



<b>Project</b>	Tweed cabinet plans				
<b>Title</b>	Champ 5F1 style cabinet - 8" Speaker				
<b>Project No.</b>	N/A	<b>Sheet No:</b>	2/2	<b>Issue</b>	A
<b>Drawn By</b>	BW	<b>Scale</b>	1: 4@A3(UNO)	<b>Date</b>	27/01/2024